

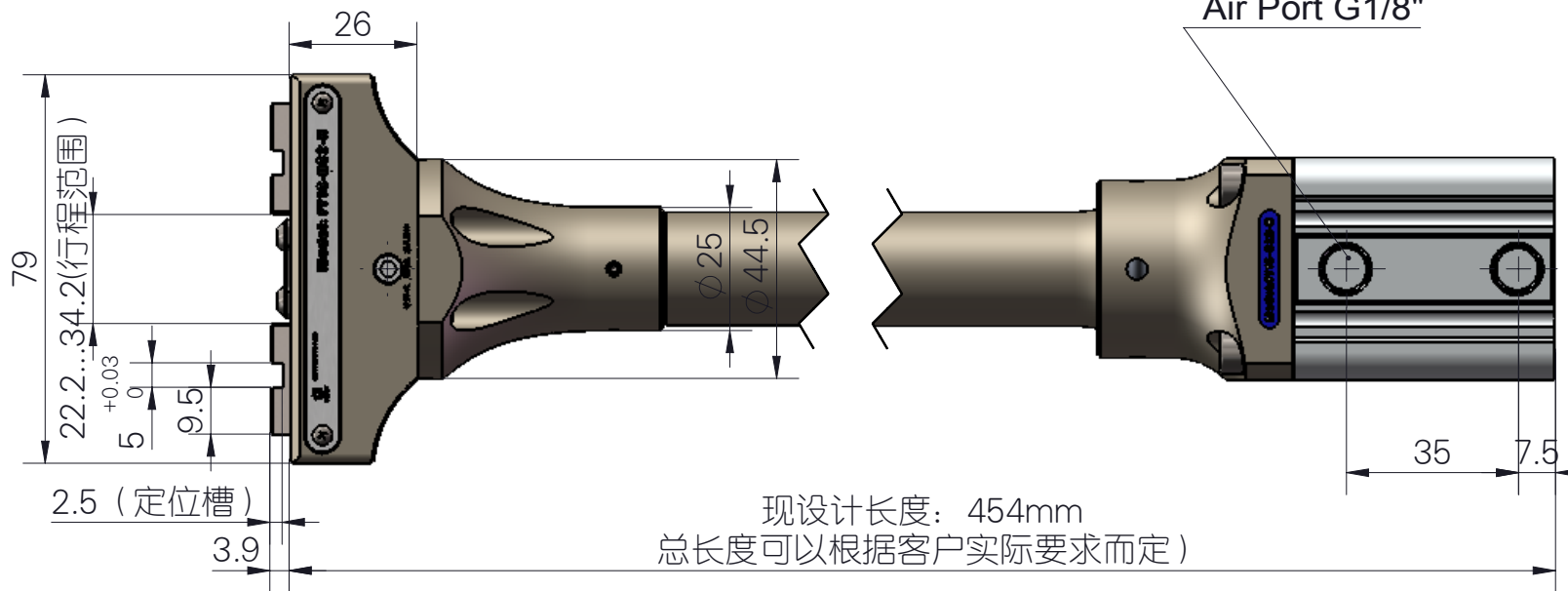

因改良等原因,规格以及外观有所变更时,不再另行通知,敬请谅解。

Without further notice if specification and exterior have been changed because of improvement thanks for your understanding

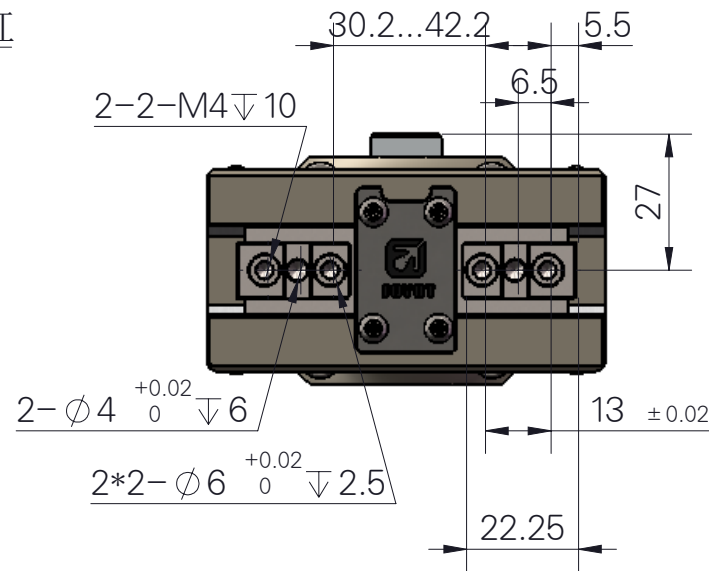
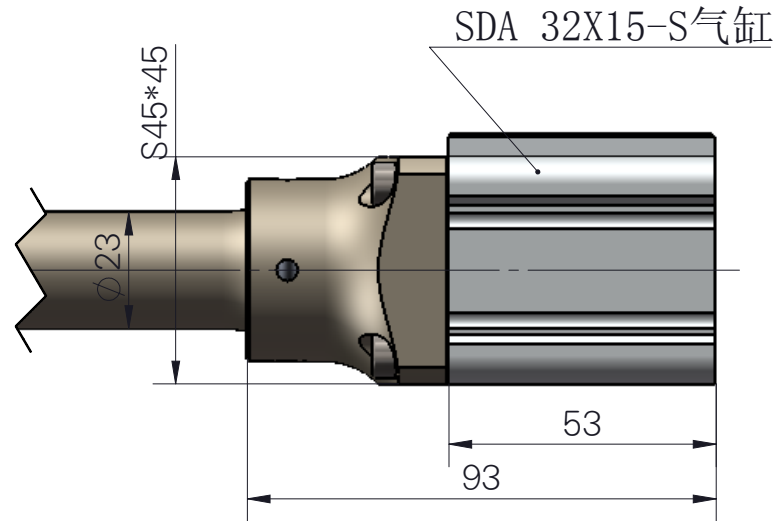
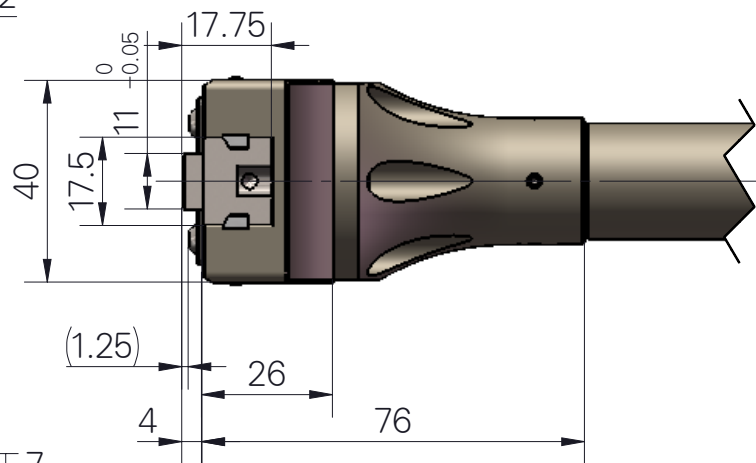

推荐的工件重量 (Recommended workpiece weight) : 2.1kg (max)

名称：导轨款耐高温锻造平行爪夹-D32

Name: Pneumatic parallel three claws

型号 (Model) : FY13-D32-H

P:空气压力 (bar) P:Air Pressure(bar)

L:到作用点距离 (mm) L:Exertion Length(mm)

开闭范围 (Stoke) :12mm

产品重量 (Weight):3.85kg (长454mm时)

最大附件长度(Max. length attach):60mm

配管连接口(Fitting size):G1/8 “

理论夹持力-开(Gripping force :Open):459NN

理论夹持力-闭(Gripping force : Close):430N

开闭时间(Closeing/Opening time):0.02/0.02sec

重复精度Repeat accuracy):0.02mm

连续使用次数(Continuation usage amount):60

使用气压(Operating pressure):3~8bar

润滑(Lubrication):不需要 (Needless)

根据IEC60529标准安全防护:IP64

所有数据在7 Bar时测量(All data were measured at 6 Bar)

重复精度:连续动作100次以后的检测值

After 100 consecutive strokes to end positions